

the complete cctv fibre optic solution for multi-mode fibre

video, audio & data transmission
over **one** multimode fibre

Vision™ 2000S series

APPLICATIONS

- Security and Surveillance
- Transportation
- Industrial Sites
- Town and City Centres
- Concierge Installations
- Government Agency Applications
- EMC Test Chamber Viewing Links
- Submersible Vehicles
- Prisons



AM Transmission Format

Lowest cost fibre optic transmission solution for high quality transmission

Built-in Receiver AGC

No installation set up or ongoing maintenance required

Transmission over Multimode Fibre

Allows the use of lowest cost fibre and termination techniques

4km Transmission Range

No repeaters required

Simultaneous Bi-directional Audio and Data

Transmission Options

Enables remote control of camera functions plus bi-directional audio

Front Panel LED Status Indicators and Rear Panel

I/O Connectors

Clear visibility of system status and ease of system cabling with reduced risk of accidental disruption

Plug in Module and Standalone Module Formats

Enables flexibility in system design, allowing choice of the most cost effective solution

configuration options range

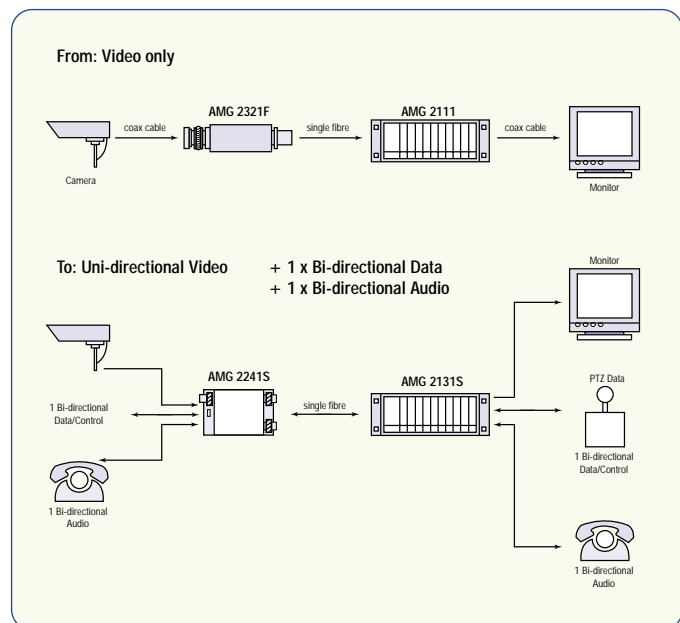

VIDEO ONLY PRODUCTS

Family Number: 2110 Video only Rx's

Part No	Enc. Type	Channel Cap
2111	Rack	Single
2113	Rack	3 channel

Family Number: 2210 Video only Rx's

2211	Standalone	Single
2213	Standalone	3 channels

Family Number: 2x20 Video only Tx's

2123	Rack	3 channels
2223	Standalone	3 Channels

Family Number: 2320 Video only Tx's

2321	Miniature	Single
------	-----------	--------

VIDEO + DATA + AUDIO PRODUCTS

Family Number: 2130 Video Rx + Data Tx/Rx + Audio Tx/Rx

Part No	Enc. Type	Interface Option
2131S	Rack	RS422/485/Lon
2132S	Rack	RS 232
2133S	Rack	20 mA
2134S	Rack	TTL
2135S	Rack	Contact Closure
2136S	Rack	FTT10ALonworks

Standalone video receiver modules are also available.

Eg.2231S=vid Rx + audio Tx/Rx + Data Tx/Rx (RS422/485)

Family Number: 2240 Video Tx + Data Tx/Rx + Audio Tx/Rx

2241S	Standalone	RS422/485/Lon
2242S	Standalone	RS232
2243S	Standalone	20mA
2244S	Standalone	TTL
2245S	Standalone	Contact Closure
2246S	Standalone	FTT10ALonworks

VIDEO + DATA PRODUCTS

Family Number: 2150 Video Rx + Data Tx/Rx

2151S	Rack	RS422/485/Lon
2152S	Rack	RS 232
2153S	Rack	20 mA
2154S	Rack	TTL
2155S	Rack	Contact Closure
2156S	Rack	FTT10ALonworks

Standalone video receiver modules are also available

E.g. 2251=video Rx + data Tx/Rx (RS422/485)

Family Number: 2260 Video Tx + Data Tx/Rx

2261S	Standalone	RS422/485/Lon
2262S	Standalone	RS 232
2263S	Standalone	20 mA
2264S	Standalone	TTL
2265S	Standalone	Contact Closure
2266S	Standalone	FTT10ALonworks

VIDEO + AUDIO PRODUCTS

Family Number: 2170 Video Rx + Audio Tx/Rx

2175S	Rack
2275S	Standalone

Family Number: 2280 Video Tx + Audio Tx/Rx

2285S	Standalone
-------	------------

POWER SUPPLIES + RACKS

System 2000 Rack mount Chassis & Power Supply

2000	19" Mount Subrack	10 module capacity
BP 2000	Blank Panel	(7 hp)

Standalone Power supply

PS2001	Power Supply +15V DC @ 300mA
--------	------------------------------

Video

input/output level	1V pk to pk nominal 1.5V pk to pk max.
Input/Output impedance	75 Ohm Unbalanced
Frequency Response - 3dB	10 Hz to 10 Mhz min video only. 10 HZ to 5.5 Mhz video/audio/data modules
Differential gain	4%
Differential phase	4
K Rating	2%
Signal to Noise Ratio	50dB

Audio

Input Impedance	47 k Ohm
Output Impedance	20 Ohm
Input level	2.2 V pk to pk nominal
Output level into 600 Ohm (bal/unbal)	2.2 V pk to pk nominal
Frequency response	50 Hz to 20 kHz
Signal to noise ratio unweighted	45dB

Data

Data rates	Up to 156 kB/s
Data interface options	TTL, RS232, RS422, RS485 (2 wire & 4 wire point to point or multi drop internal Tx control) 20mA current loop, Echelon Lonworks + contact closure

Optical

Wavelength	850/1300 nm LED
Fibre dimensions	Multi mode 50/125 upwards
Optical connector type	ST
Path loss	10 dB minimum 50/125 micron fibre 13 dB minimum 62.5/125 fibre

General

Operating Temperature	-15 to +65 C
Operating Humidity	0 to 95% non condensing
Video connector	BNC
Emissions	CE Approved
Mechanical	Standalone or Rack mount modules miniature video only transmitter (see mechanical data sheet)

Power Supply Requirements

2321F	Mini video transmitter + 11V to +16V DC/30mA MAX
2200 VTX Modules	+12V to +18V DC/250mA MAX
2200 VRX Modules	+15V to + 18V DC 250mA MAX

AMG Systems Limited reserves the right to change the specification without notice. The information herein is believed to be reliable and accurate, however no responsibility is assumed by AMG Systems Limited for it's use.

